

INSTALLATION INSTRUCTIONS

DESCRIPTION: Rock Slider Kit
PART NUMBER: B4M-F11D0-V0
MODEL: 2021+ Wolverine RMax2



⚠ WARNING

Please read and understand these instructions completely before installation to avoid possible injury, or damage to the accessory or vehicle.

NOTICE:

Installation of this kit requires a torque wrench and should be performed by an authorized Yamaha dealer or a qualified mechanic.

WARRANTY INFORMATION:

In the United States, see your Yamaha dealer for a copy of the Yamaha Genuine Parts and Accessories Limited Warranty.

DEALER OR INSTALLER:

These instructions contain important information for future reference and *must* be given to the customer.

PARTS LIST:

No.	Part Number	Description	Qty
--	B4M-F11D0-V0	Rock Slider Kit	--
①	-	Rock Slider, Left	1
②	-	Rock Slider, Right	1
③	95812-10030	M10x30 Flange Bolt	4
④	BG4-F1736-T0	Nut Plate	2
⑤	-	Caution Label	2
⑥	97017-06020	M6x20 Flanged Bolts	6
⑦	92907-06200	M6 Flat Washer	6
⑧	92902-10200	M10 Flat Washer	4
⑨	B4M-F1279-V0	Blind Plug	2

* Part supplied with kit only and not available separately.

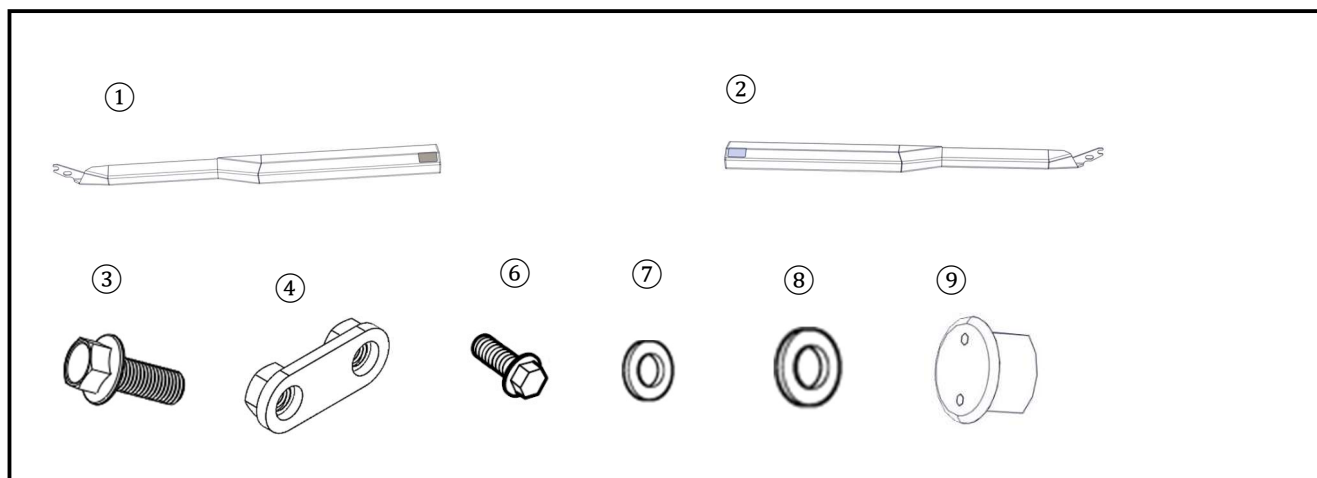

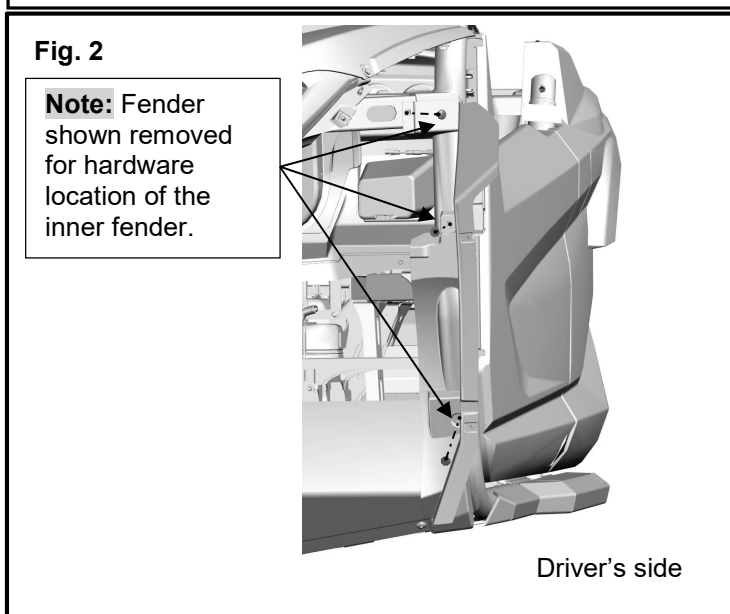
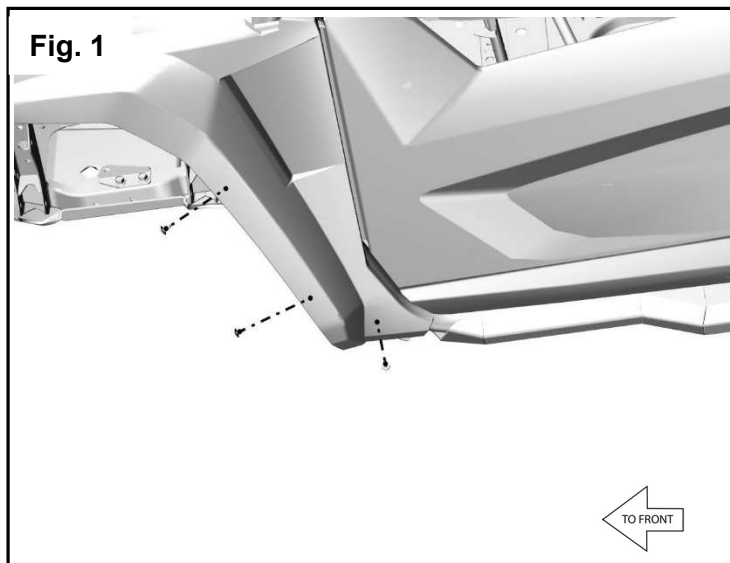

PREPARATION:

- Place the vehicle on a secure and level surface.
- Set the parking brake.
- Clean the mount surfaces before beginning installation.

PARTS REMOVAL:

1. Loosen both front pillar guards and retain all hardware for reuse. There are three bolts on each side. (Fig. 1)
Note: The front fender bolt can stay in place to hold the fender to the body.
2. Loosen both front mudguards, there are three bolts in the inner fender area to be removed and three bolts in the foot well to loosen. Retain hardware for reuse. (Fig. 2, 3 and 4)

INSTALLATION:

1. Remove the end cap and the button head bolt in the side of the frame so the rear hardware can be installed.
2. Insert ⑨ Blind Plug with the holes horizontal to the ground and into the frame. Slide the ① Rock Slider over the mounting holes and into the front section of the frame. (Fig. 5)
3. Thread three ⑥ M6x20mm Hex Head Bolts and three ⑦ M6 Flat Washers into the rear of the ① Rock Slider. The two bolts in the ⑨ Blind Plug are torqued to 10 Nm (1.0 kg-m or 7.3 lb-ft). The inner ⑥ M6x20mm Hex Head Bolt is torqued to 5 Nm. (0.5 kg-m or 3.6 lb-ft) (Fig. 6)
4. Align the ① Left Rock Slider on the front left side of the vehicle.
5. Just behind the front wheel, hold the ④ Nut Plate against the inside tab on the ① Rock Slider in the front. Thread two ③ M10x30mm

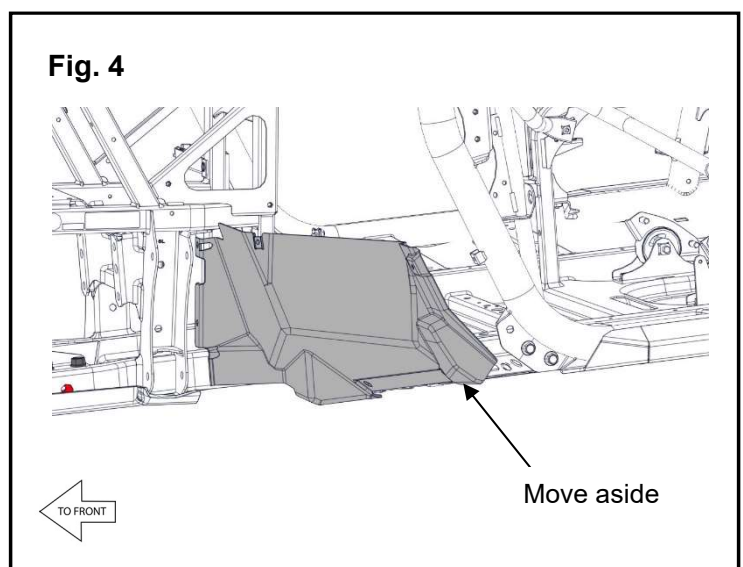
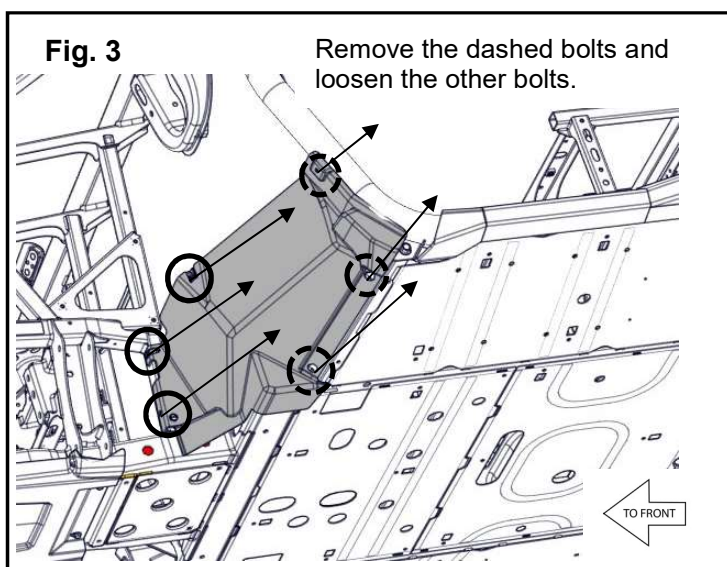

Fig. 5

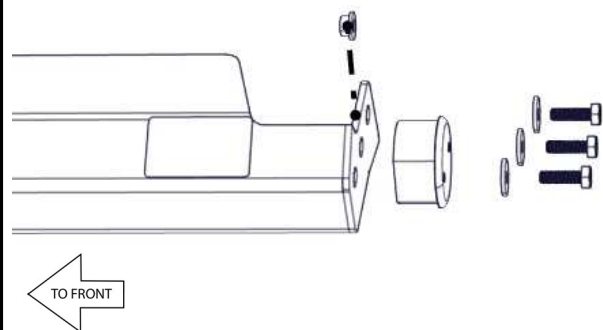

Fig. 6

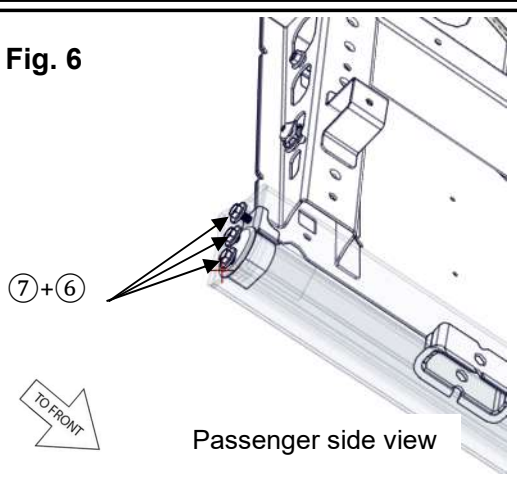
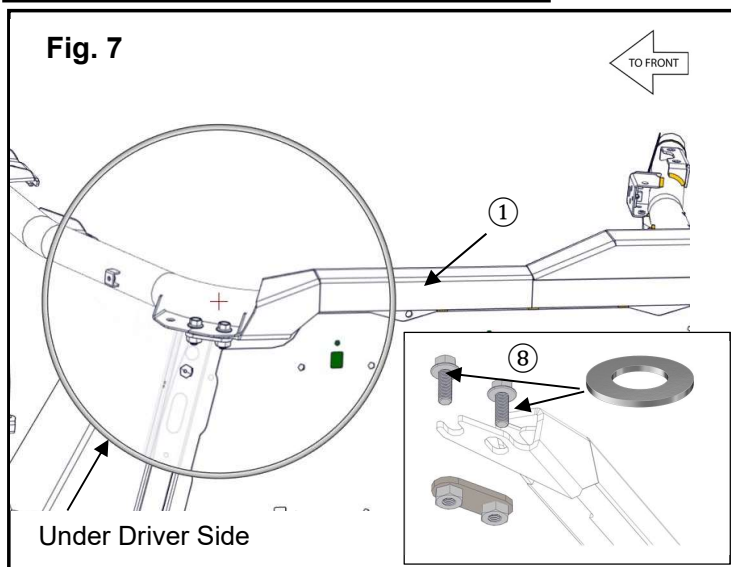

Fig. 7



Flanged Bolts and two (8) M10 Flat Washers through the frame and into the (1) Rock Slider. (Fig. 6)

6. Torque the four (3) M10x30mm Flanged Bolt bolts to 47 Nm (4.7 kg-m or 34.6 lb-ft)
7. Repeat Steps 1 through 6 for the other side of the vehicle for (2) Right Rock Slider.
8. Reinstall the mudguards and torque the hardware to 7Nm (0.7 kg-m or 5.2 lb-ft). (Fig. 2)
9. Reattach the inner front fender and torque the bolts to 7Nm (0.7 kg-m or 5.2 lb-ft). (Fig. 1)
10. Reattach the fender to the inner fender and torque the hardware to 7Nm (0.7 kg-m or 5.2 lb-ft).

MAINTENANCE:

Periodically, check torque on all hardware. If loose hardware is found, re-torque to specification.

CARE AND CLEANING:

Clean painted metal parts with a clean soft cloth and mild soap and water solution. Rinse and dry.

CUSTOMER SERVICE:

For further information see your Yamaha dealer.

ESTIMATED TIME TO INSTALL: 1.0 HRS.